

20 422 000 **BAULoop STANDHANE 1/2"**
XS-SIZE

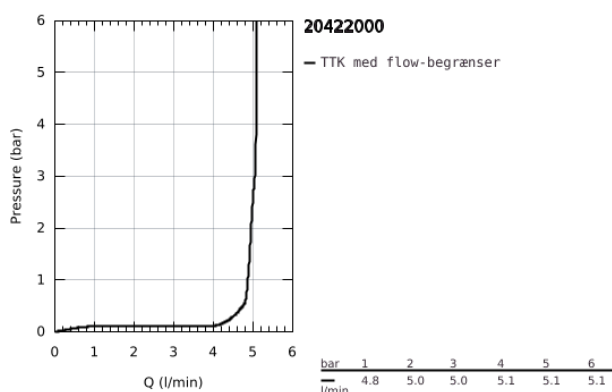

PRODUKTBESKRIVELSE

- Farve: chrome
- Ethulsmontage
- metalgreb
- keramisk overdel 1/2", 90°
- GROHE Long-Life-belægning
- GROHE Water Saving - reducerer vandforbruget og giver en perfekt gennemstrømning
- maximum flow rate (at 3 bar): 5 l/min
- fikseringsmøtrik G 1/2"

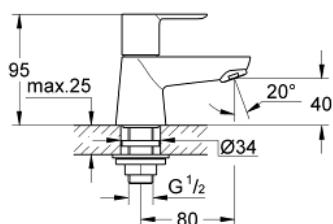

20 422 000 **BAULoop STANDHANE 1/2"**
XS-SIZE

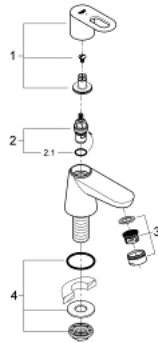

RESERVEDELE , september 2012 – now

- 1: Greb (Bestillingsnummer 48027000)
- 2: Keramisk overdel 1/2" (Bestillingsnummer 45882000)
- 2.1: O-ring Ø18,2 x Ø1,7 (Bestillingsnummer 0392400M)
- 3: Perlator (Bestillingsnummer 13952000)
- 4: Monteringsset til Zedra / Minta (Bestillingsnummer 45004000)